

MOD 4925 / 4900

304

INDOOR	□	
13.4925.040.12	40 x 40 x 2,0	L = 2500 mm
13.4900.040.12	40 x 40 x 2,0	L = 5000 mm

316

OUTDOOR	□	
14.4925.040.12	40 x 40 x 2,0	L = 2500 mm
14.4900.040.12	40 x 40 x 2,0	L = 5000 mm

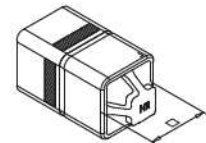
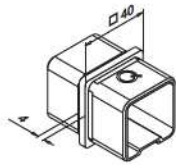

MOD 4790

304

INDOOR	□	
13.4790.040.12	40 x 40	2

316

OUTDOOR	□	
14.4790.040.12	40 x 40	2



MOD 5792 - EASY HIT®

316

Raw

OUTDOOR	□	
14.5792.040.00	for 40 x 40	2



International Design Model Protection

Q-INFO

MOD 5792

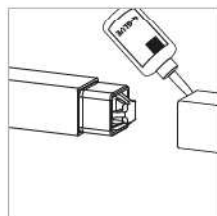
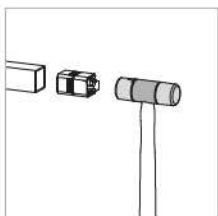

Q-21
Q-glue
50 ml
19.1331.000.00

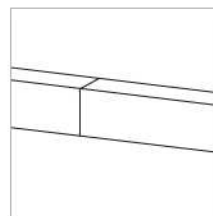

Q-INFO

MOD 4925 / 4900

Calculation basis for tubes

calculated by

	□(mm)	A (cm ²)	I _x =I _y (cm ⁴)	W _x =W _y (cm ³)	M (kg/m)	R _{p0,2} (kN/cm ²)	R _m (kN/cm ²)
13.4900.040.12 / 13.4925.040.12	40 x 40	3,04	7,30	1,83	2,38	23	54
14.4900.040.12 / 14.4925.040.12	40 x 40	3,04	7,30	1,83	2,38	24	53

A = cross sectional area
I_x / I_y = second moment of area
W_x / W_y = section modulus
M = weight
R_{p0,2} = permissible stress
R_m = minimum tensile strength